

# Motor M48 with worm gear SN31

- zinc die-cast gearhousing, hardened steel worm wheel, permanent grease lubrication, output with ball bearing, optional second shaft or output shaft left
- Other reductions, output shaft or connection cable on request

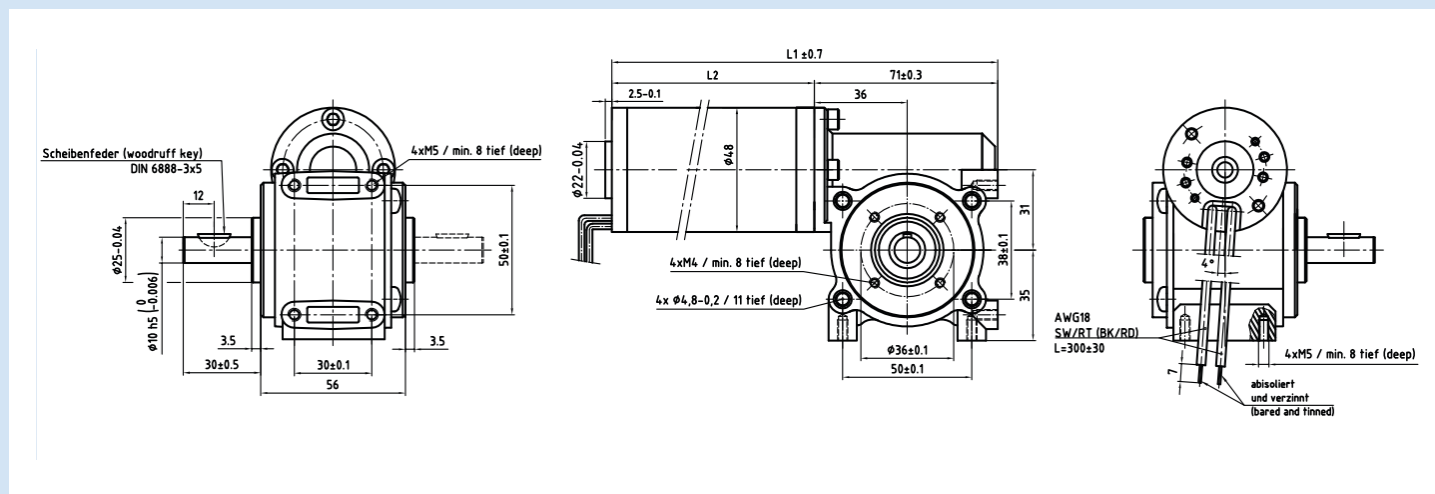

## Gear reduction table M48xXX/I+ SN31

Application on request

| Gear reduction | Efficiency of the gear | Speed at motor-speed 3000rpm | Nominal torque in S1-operation |                        |                         |                         |
|----------------|------------------------|------------------------------|--------------------------------|------------------------|-------------------------|-------------------------|
|                |                        |                              | M48x25/I<br>L2 = 91 mm         | M48x28/I<br>L2 = 91 mm | M48x50/I<br>L2 = 116 mm | M48x60/I<br>L2 = 126 mm |
| [i = x:1]      | [%]                    | [1/min]                      | [Ncm]                          | [Ncm]                  | [Ncm]                   | [Ncm]                   |
| 7              | 69                     | 428,5                        | 24,15                          | 48,3                   | 48,3                    | 72,45                   |
| 10             | 66                     | 300                          | 33                             | 66                     | 66                      | 99                      |
| 15             | 62                     | 200                          | 46,5                           | 93                     | 93                      | 139,5                   |
| 25             | 52                     | 120                          | 65                             | 130                    | 130                     | 195                     |
| 38             | 46                     | 78,9                         | 87,4                           | 174,8                  | 174,8                   | 262,2                   |
| 50             | 40                     | 60                           | 100                            | 200                    | 200                     | 300                     |

| Gear reduction | Efficiency of the gear | Speed at motor-speed 3000rpm | Nominal torque in S3-operation |                        |                         |                         |
|----------------|------------------------|------------------------------|--------------------------------|------------------------|-------------------------|-------------------------|
|                |                        |                              | M48x25/I<br>L2 = 91 mm         | M48x28/I<br>L2 = 91 mm | M48x50/I<br>L2 = 116 mm | M48x60/I<br>L2 = 126 mm |
| [i = x:1]      | [%]                    | [1/min]                      | [Ncm]                          | [Ncm]                  | [Ncm]                   | [Ncm]                   |
| 7              | 78                     | 428,5                        | 40,95                          | 81,9                   | 81,9                    | 122,86                  |
| 10#            | 79                     | 300                          | 59,25                          | 118,5                  | 118,5                   | 177,75                  |
| 15#            | 77                     | 200                          | 86,63                          | 173,25                 | 173,25                  | 259,88                  |
| 25             | 58                     | 120                          | 108,75                         | 217,5                  | 217,5                   | 326,25                  |
| 38             | 50                     | 78,9                         | 142,5                          | 285                    | 285                     | 427,5                   |
| 50             | 44                     | 60                           | 165                            | 330                    | 330                     | 496                     |

\*) Motor have to be operated with current limitation

#) plastic design

## General gear data

|                        |                         |           |           |
|------------------------|-------------------------|-----------|-----------|
| Material worm wheel    |                         | Plastic   | Brass     |
| Maximum torque         | [Ncm]                   | 800       | 1200      |
| Permissible shaft load | [N]<br>(axial / radial) | 200 / 500 | 200 / 500 |
| Gear length            | [mm]                    | 71        | 71        |

Stand: 24. Juli 2020 – changes reserved