

# Motor M63 with worm gear SN31

- zinc die-cast gearhousing, hardened steel worm wheel, permanent grease lubrication, output with ball bearing, optional second shaft or output shaft left
- Other reductions, output shaft or connection cable on request

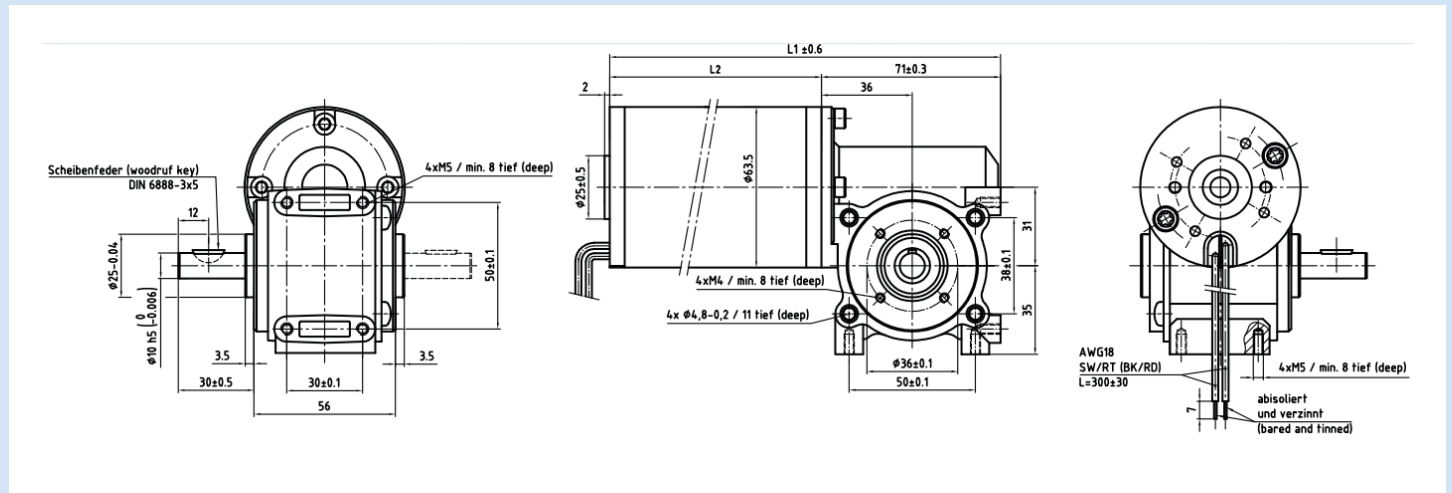

## Gear reduction table M63xXX/I+ SN31

Application on request

Gear reduction	Efficiency of the gear	Speed at motor-speed 3000rpm	Nominal torque in S1-operation			
			M63x25/I L2 = 95 mm	M63x40/I L2 = 110 mm	M63x60/I L2 = 130 mm	
[i = x:1]	[%]	[1/min]	[Ncm]	[Ncm]	[Ncm] 12V	[Ncm] 24V
7	69	428,5	67,62	86,94	106,26	144,9
10	66	300	92,4	118,8	145,2	198
15	62	200	130,2	167,4	204,6	279
25	52	120	182	234	286	390
38	46	78,9	244,72	314,64	384,56	524,4
50	40	60	280	360	440	600

Gear reduction	Efficiency of the gear	Speed at motor-speed 3000rpm	Nominal torque in S3-operation			
			M63x25/I L2 = 95 mm	M63x40/I L2 = 110 mm	M63x60/I L2 = 130 mm	
[i = x:1]	[%]	[1/min]	[Ncm]	[Ncm]	[Ncm] 12V	[Ncm] 24V
7	78	428,5	114,66	147,42	180,18	245,7
10 <sup>#</sup>	79	300	165,9	213,3	260,7	355,5
15 <sup>#</sup>	77	200	242,55	311,85	381,15	519,75
25	58	120	304,5	391,5	478,5	652,5
38	50	78,9	399	513	627	855
50	44	60	462	594	726	990

\*) Motor have to be operated with current limitation

#) plastic design

## General gear data

Material worm wheel		Plastic	Brass
Maximum torque	[Ncm]	800	1200
Permissible shaft load	[N] (axial / radial)	200 / 500	200 / 500
Gear length	[mm]	71	71

Stand: 24. Juli 2020 – changes reserved